

# www.ThermalShell.com

## Advanced Engineering & Materials for Green Energy Efficient Buildings

New Generation Precast 8" Wall Panels Outperform Competitions:  
*Up to 4 times lighter and 4 times higher R-Value*

Ingenious synergy of polyurethane super-insulations (**30+ R-values**) with optima structural integrity of finished steel and proprietary, decorative concrete facade. The overall-best wall and roof panel:



- ◆ **Advanced Optimization Engineering**
- ◆ **Advanced Proprietary Concrete**
- ◆ **Advanced Polyurethane**

Intergration and optimization of superior compression concrete properties with exceptional tensile steel properties, and superior insulation and adhesive properties of polyurethane, results in advanced hybrid panels that provide energy savings from 60% to 85% or more ... [[products](#)]

### Environmental Advantages

- Saving energy directly reduces use of fossil fuel
- Reduced energy requirement enables use of renewable energy
- Reduced environmental pollution proportional to reduced energy use

### Environmental Impact

- **114 million** tons of CO<sub>2</sub> produced due to energy consumption in U.S. Buildings
- **67,000** tones of Sox
- **35,000** tones of NO<sub>x</sub>

### Building Energy Consumption

- **40%** total energy used in U.S.

## Traditional Cement Panels versus ThermalShell® Panels

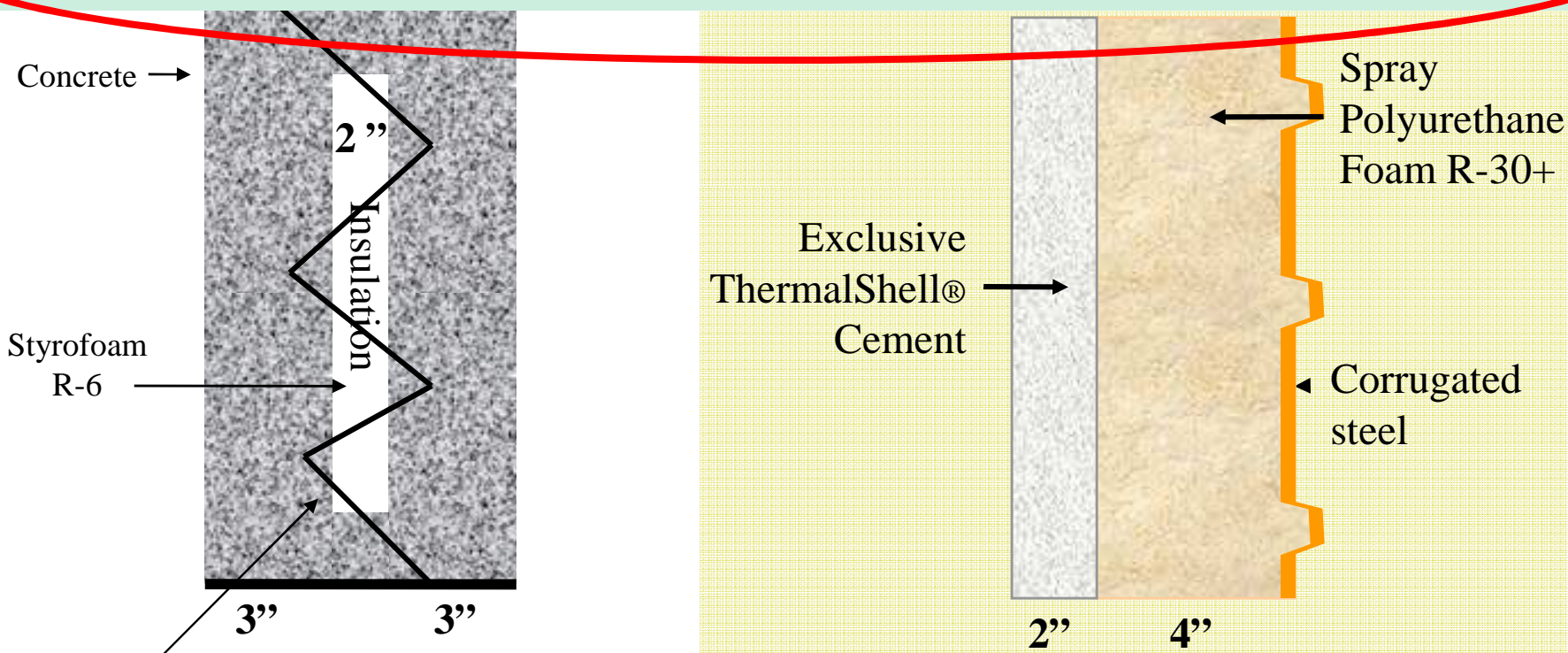

**Advanced Engineering & Materials for Green Energy Efficient Buildings**  
**New Generation Precast 8" Wall Panels Outperform Competitions:**  
***Up to 4 times lighter and 4 times higher R-Value***



## Advantages for All

### Advantages for Building Owners:

- Substantially lower heating/cooling energy cost
- Require smaller size heating & A/C equipment resulting in additional cost saving
- ThermalShell walls do not have local/thermal-bridging cold-spots and associated condensation problems
- Improved thermal uniformity without localized adverse temperatures provides better comfort at the same temperature settings
- Structurally strong and safe building
- Reduction in outside noise pollution
- Storm resistant and fire resistant
- Mold/mildew/rot resistant & vermin & termite resistant

### Advantages for Architects & Builders:

- Unlimited design flexibility
- Compliments sustainable design architecture
- Incorporates green building principles
- Unlimited wall finish options
- Suitable for residential, commercial, industrial/warehouse buildings
- Pre-engineered project design
- Pre-manufactured panels arrive ready to set
- Faster construction time
- Smaller construction time
- Smaller work crews
- Provide your clients with the best wall systems available

### Related Links

- [Energy Efficiency in Buildings](#)
- [Office of Energy Efficiency and Renewable Energy's \(EERE\)](#)
- [EERE Building Technologies Program](#)
- [Obama Administration Announces \\$3.2 Billion for Energy Efficiency Improvements](#)
- [Department of Energy and Commercial Real Estate Executives Launch Alliance to Reduce Energy Consumption of Buildings](#)
- [Summary of Energy Tax Incentives in The Emergency Economic Stabilization Act of 2008](#)



## Satisfied Customers



Keeley Construction,  
erected due to approved  
ThermalShell® panels in  
Chicago, IL.



ThermoFisher Scientific, a  
Fortune 500 company



## Additional TST Properties

### The Grill House Restaurant and Banquet Hall

Location:  
Alegan, MI  
Size:  
12,000 Sq.ft.



### Colonial Coach Lines

Location:  
Mt. Prospect, IL  
Size: 7,500 Sq.ft.



### Virginia Commonwealth University

Location:  
Richmond, VA



### TAILS Humane Society

Location:  
DeKalb, IL  
Size: 7,500 Sq.ft.

